

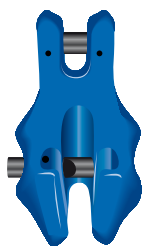

Green Pin® Shortening Clutch with Lock GR10

Grade 10 shortening clutch with locking pin

- **Material:** alloy steel, grade 10, quenched and tempered
- **Safety factor:** MBL equals 4 x WLL
- **Finish:** painted blue
- **Temperature range:** -40°C up to +200°C
- **Certification:** 2.1 2.2 3.1 MPI[®]



UGCV

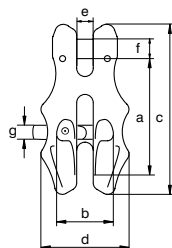

for chain diameter		working load limit	length	width inside	length	width outside	width	diameter pin	diameter pin	weight each
mm	inch	t	a mm	b mm	c mm	d mm	e mm	f mm	g mm	kg
6	⁷ / ₃₂	1.4	51	23	75	42	7	8	7	0.23
8	⁵ / ₁₆	2.6	67	30	94	50	9	10	8	0.44
10	³ / ₈	4	79	38	116	63	12	13	12	0.76
13	¹ / ₂	6.8	103	49	149	79	15	16	16	1.67
16	⁵ / ₈	10.3	128	60	184	99	19	20	20	3.1
20	³ / ₄	16	154	75	215	124	23	24	20	4



Green Pin® Shortening Clutch with Double Lock GR10

Grade 10 shortening clutch with double locking pin

- **Material:** alloy steel, grade 10, quenched and tempered
- **Safety factor:** MBL equals 4 x WLL
- **Finish:** painted blue
- **Temperature range:** -40°C up to +200°C
- **Certification:** 2.1 2.2 3.1 MPI[®]



UGDC

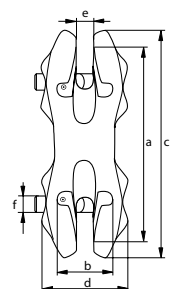

for chain diameter		working load limit	length	width inside	length	width outside	width	diameter pin	weight each
mm	inch	t	a mm	b mm	c mm	d mm	e mm	f mm	kg
6	⁷ / ₃₂	1.4	99	23	120	42	7	7	0.49
8	⁵ / ₁₆	2.6	112	30	140	50	9	8	0.77
13	¹ / ₂	6.7	178	49	208	79	15	16	2.85